

K2 Access Wall Unit

Intelligent access control access unit

Our new K2 self-contained entry control access unit from the ACS-WL product portfolio supports door opening via Bluetooth, mobile app, remote control or EM RFID media (Mifare 13.56 MHz, tag, wristband, etc.).

Our intelligent access unit will impress you with its performance, reliability and durable machine construction. Access control is possible by using e.g. a card & numeric code & Bluetooth & Wifi & mobile app.

It is used in apartment buildings, administrative buildings, offices, factories, family houses, hotels, apartment houses, but also, for example, Airbnb. It is easy to install, program and operate.

PROPERTIES

- : Aluminum frame with tempered glass panel - durable
- : Anti-vandal function
- : Identification - by RFID chip, Bluetooth, mobile application, numerical code or remote control
- : Possibility of control - locks, automatic doors, door drives, barriers, gates, alarms, exit button
- : Very simple operation
- : Mobile application programming
- : Dimensions: 125x79x15.5 mm
- : Capacity up to 20000 cards
- : Possibility of connection with other units
- : Suitable for controlling access to buildings from family houses to large businesses



SPECIFICATIONS

Voltage source :	12V
Standby current:	≈5mA
Operating voltage:	≈1A
Time to unlock in seconds:	≈1.5s
Communication:	Bluetooth 4.1
Supported system:	Android 4.3/IOS7.0 above
Material:	Tempered glass panel
Dimensions:	125mm×79mm×15,5mm
Water resistance level:	IP 66
Card capacity:	20000 cards

Způsob odemknutí: Unlock method

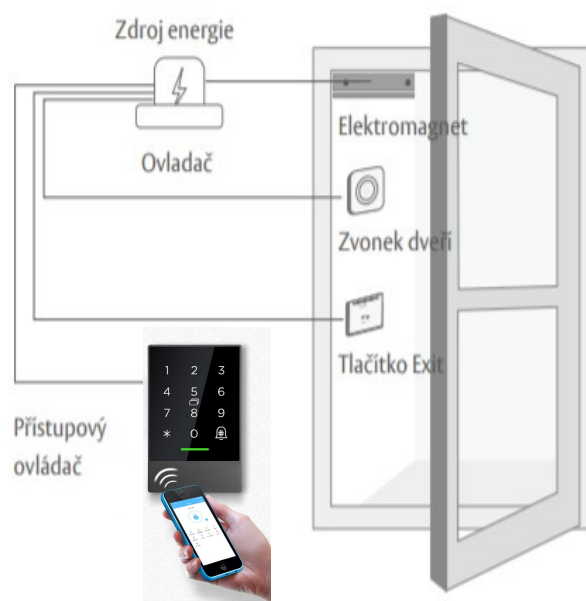

www.acssolution.cz

The leader in door opening solution

Updated: 2/2023 | ACS Solution s.r.o. Specifications can subject to change without prior notice. Note: The colors of the images in this brochure may differ from the actual colors.